

# GH2<sup>®</sup> ARCHITECTS

## Design. Service. Solutions.<sup>®</sup>





**51** years of continuous service

**100** design professionals across  
four offices with HQ in Tulsa

2x AIA Eastern Oklahoma

1x AIA Central Oklahoma

**Firm of the Year**

more than **120** industry awards for  
**GREAT PROJECTS AND GREAT PEOPLE**

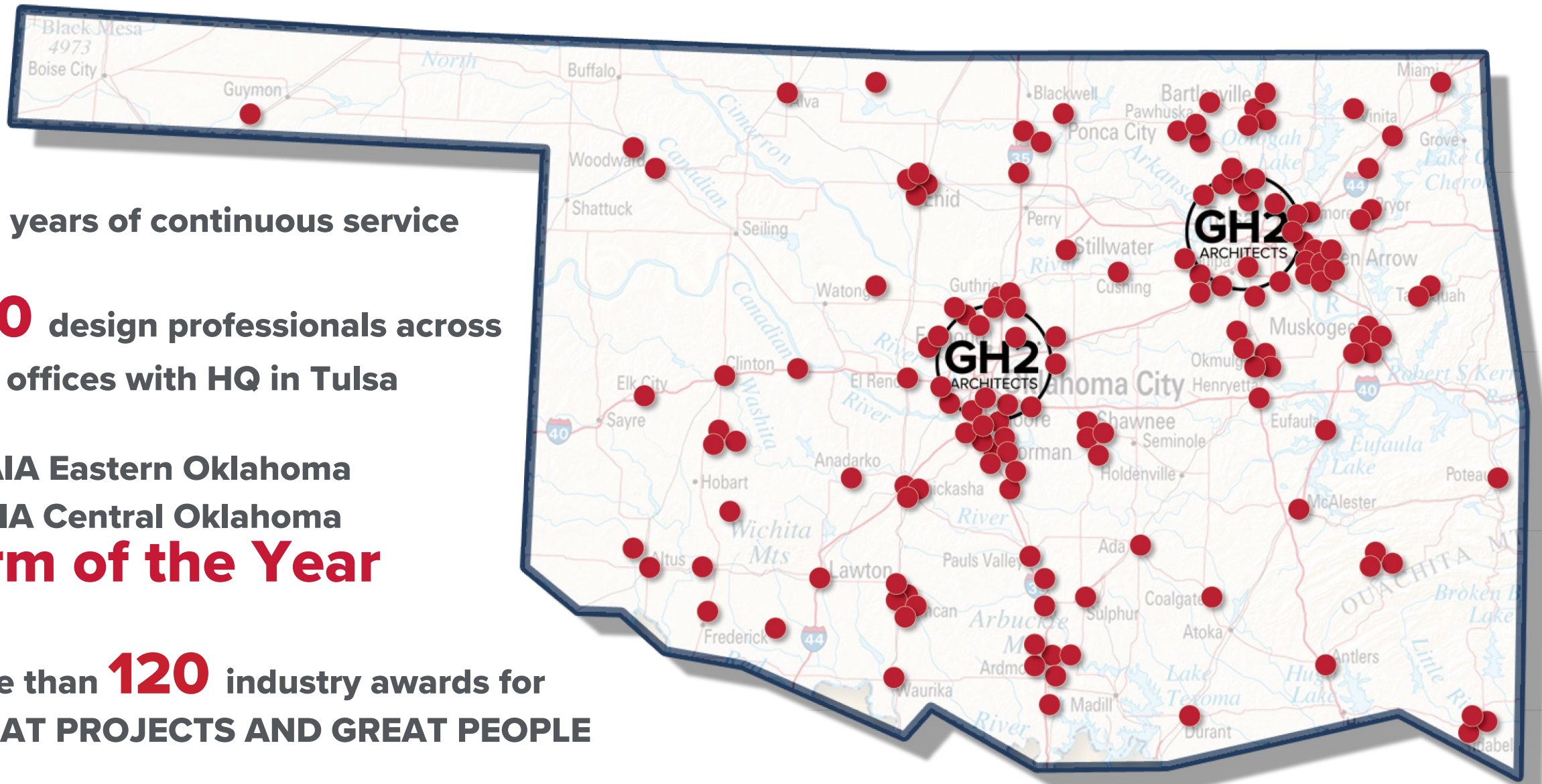





Arenas & Event Centers



Civic & Government



Commercial



Community & Non-Profit



Education



Equine



Financial Institutions



Healthcare



Historic Preservation



Hospitality



Industrial & Warehouse

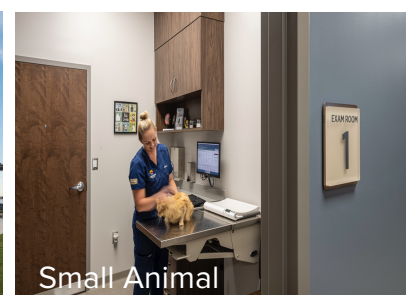

Small Animal



Worship



Master Planning



Office & Workplace



On-Call & IDIQ

We work in nearly every practice area and offer specialized design services in hospitality, equestrian, and historic preservation architecture.



**Delivery Method: CM (Thompson Construction)**

**Size: 75,000 SF**

**Estimated Bid Advertisement Date: July 2024**

**\*consultant to Blue River Architects**



**blue river**  
ARCHITECTS

**CHEROKEE NATION | Tahlequah Wellness Center\***

**GH2**





**Delivery Method: CM (TBD)**

**Size: 66,000 SF**

**Estimated Bid Advertisement Date: July 2024**

**\*consultant to Blue River Architects**

**CHEROKEE NATION | Sequoyah High School Multipurpose Athletic Facility\***

**GH2**



**Delivery Method: CM (Timberlake Construction)**

**Size: 30,000 SF**

**Estimated Bid Advertisement Date: Aug 2024**



**OKLAHOMA CITY PUBLIC SCHOOLS | Jefferson Middle School Addition**

**GH2**



**Delivery Method: CM (Timberlake Construction)**

**Size: 190,000 SF**

**Estimated Bid Advertisement Date:**

**Civil: Aug 2024**

**Building: Oct 2024**





**Delivery Method: CM (TBD)**

**Size: 65,000 SF**

**Estimated Bid Advertisement Date: Sept 2024**

**\*consultant to Blue River Architects**



 **blue river**

**IMMERSION MIDDLE SCHOOL**



**CHEROKEE NATION | Immersion Middle School\***

**GH2**



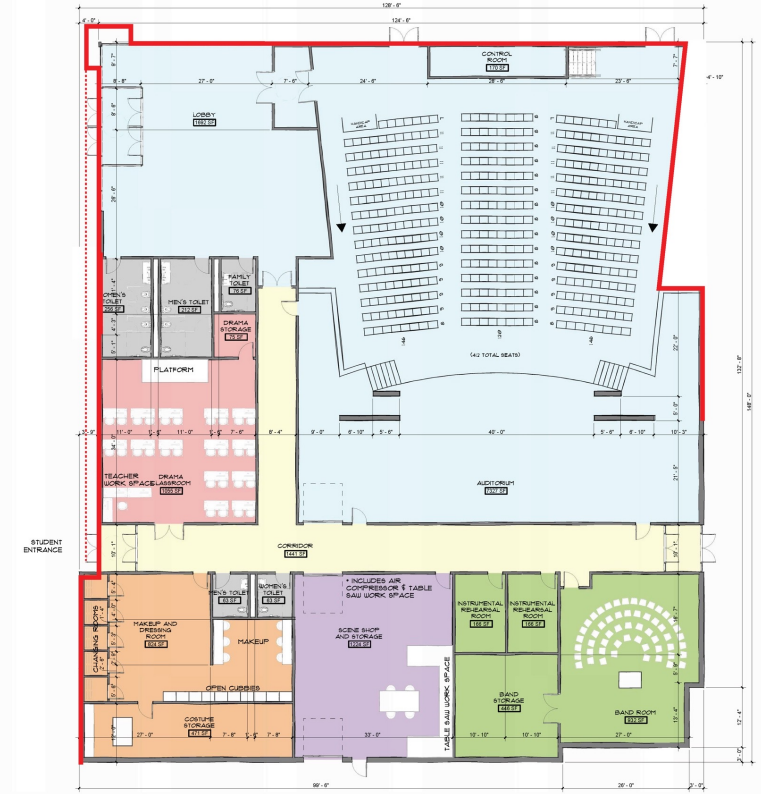

**Delivery Method: CM (TBD)**

**Size: 47,000 SF**

**Estimated Bid Advertisement Date: Nov 2024**

**\*consultant to Blue River Architects**





**Delivery Method: CM (Thompson Construction)**  
**Size: 30,000 SF**  
**Estimated Bid Advertisement Date: Nov 2024**





**Delivery Method: CM (Manhattan Construction Group)**

**Size:**

**Phase 1: 27,000 SF (90% renovation)**

**Phase 2: 25,000 SF (new)**

**Estimated Bid Advertisement Date: Jan 2025**

**CASCIA HALL | Science and Student Life Facility**

**GH2**



**Delivery Method: CM (Flintco Construction)**  
**Size: 300,000 SF**  
**Estimated Bid Advertisement Date: Jan 2025**



**TULSA TECH | Lemley Campus Phase III (Career Excellence Center)**

**GH2**



**Delivery Method: CM (Miller-Tippens Construction)**

**Size: 11,000 SF**

**Estimated Bid Advertisement Date: Jan 2025**





**Delivery Method: CM (Miller-Tippens Construction)**

**Size: 7,000 SF**

**Estimated Bid Advertisement Date: March 2025**





# ROSEWOOD ELEMENTARY 16

**Delivery Method: CM (Miller-Tippens Construction)**

**Size: 9,000 SF**

**Estimated Bid Advertisement Date: March 2025**

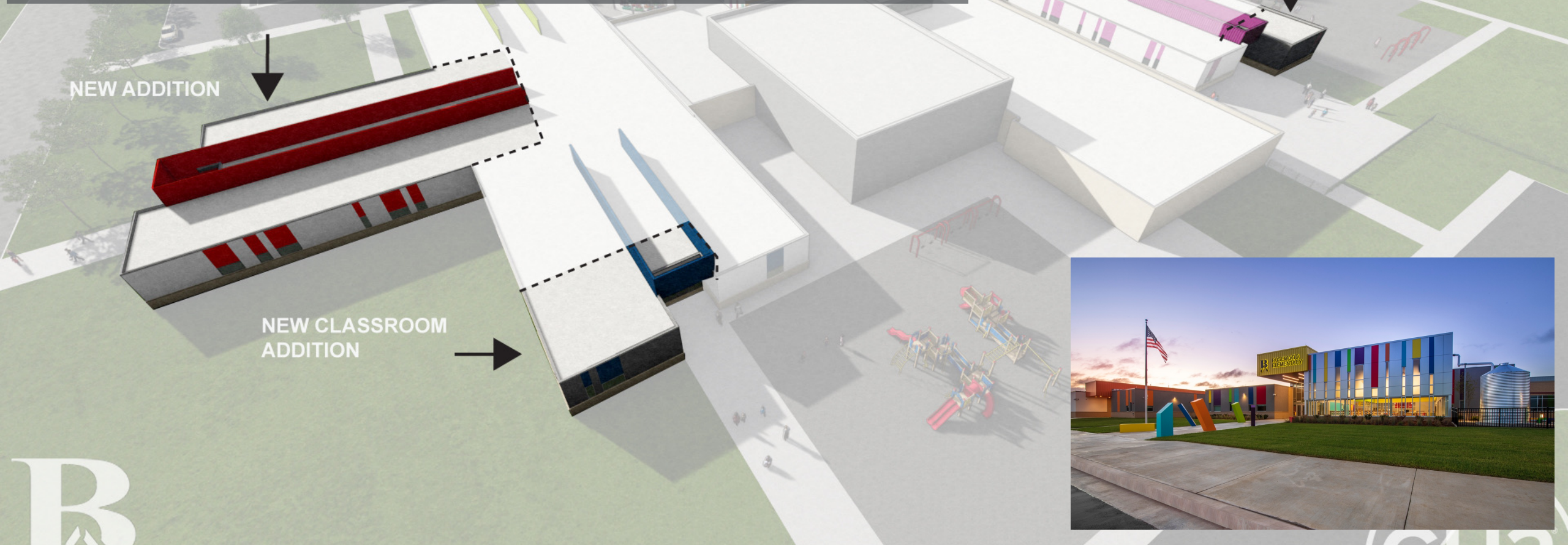





**Delivery Method: CM (TBD)**  
**Size: 36,000 SF**  
**Estimated Bid Advertisement Date: April 2025**